

ARCHITECTURE / ENGINEERING / INTERIORS

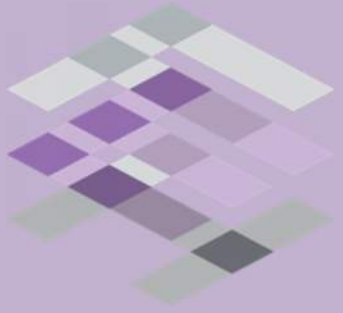

FEH DESIGN

SUN PRAIRIE PUBLIC LIBRARY

LIBRARY BOARD MEETING
09 DECEMBER 2021



SUN PRAIRIE
PUBLIC LIBRARY

01 / GOALS FOR SUCCESS

- Ensure that we serve the community needs for the next 20 years
- Grow with Sun Prairie socio- economic needs
- Improve infrastructure for comfort, aesthetics, safety, and security
- Core Values tied to physical space to reflect culture
- Provide adequate space to support collections and programs
 - Consideration for flexible space and outdoor spaces including a Maker Space
 - Space for Foundation Executive Director and Storage
- Remove barriers to serve all members of our community
- Provide more flexible access
 - Consideration to maintain and enhance the drive-up window to serve patrons
- Be an example by being good stewards - financially, environmentally and culturally sustainable
- Library as an essential destination
- Promote and foster life-long learning and creativity
- Create an environment that continues to be comfortable...maintain current integrity of our “GEM” inside and outside
- Exposure to Art – local and national
- Facilitate communication using technology
- Provide broad and diverse collection access for the community

02 / 2021 CONCEPT

CURRENT STUDY



02/ UPDATED CONCEPT 5A

BUDGET - \$19,933,000



03 / PLAN REVISIONS

OPTION 5A CHANGES

- Slide makerspace adjacent to Media Center
- Identify Multicultural Areas throughout space
- Identify and develop staff spaces
- Add study rooms to teen space
- Move youth Storytime space to NE corner
- Single library entrance
- Foundation Director space allocation
- Identify aquarium and art wall locations

04/ CONCEPT 5A

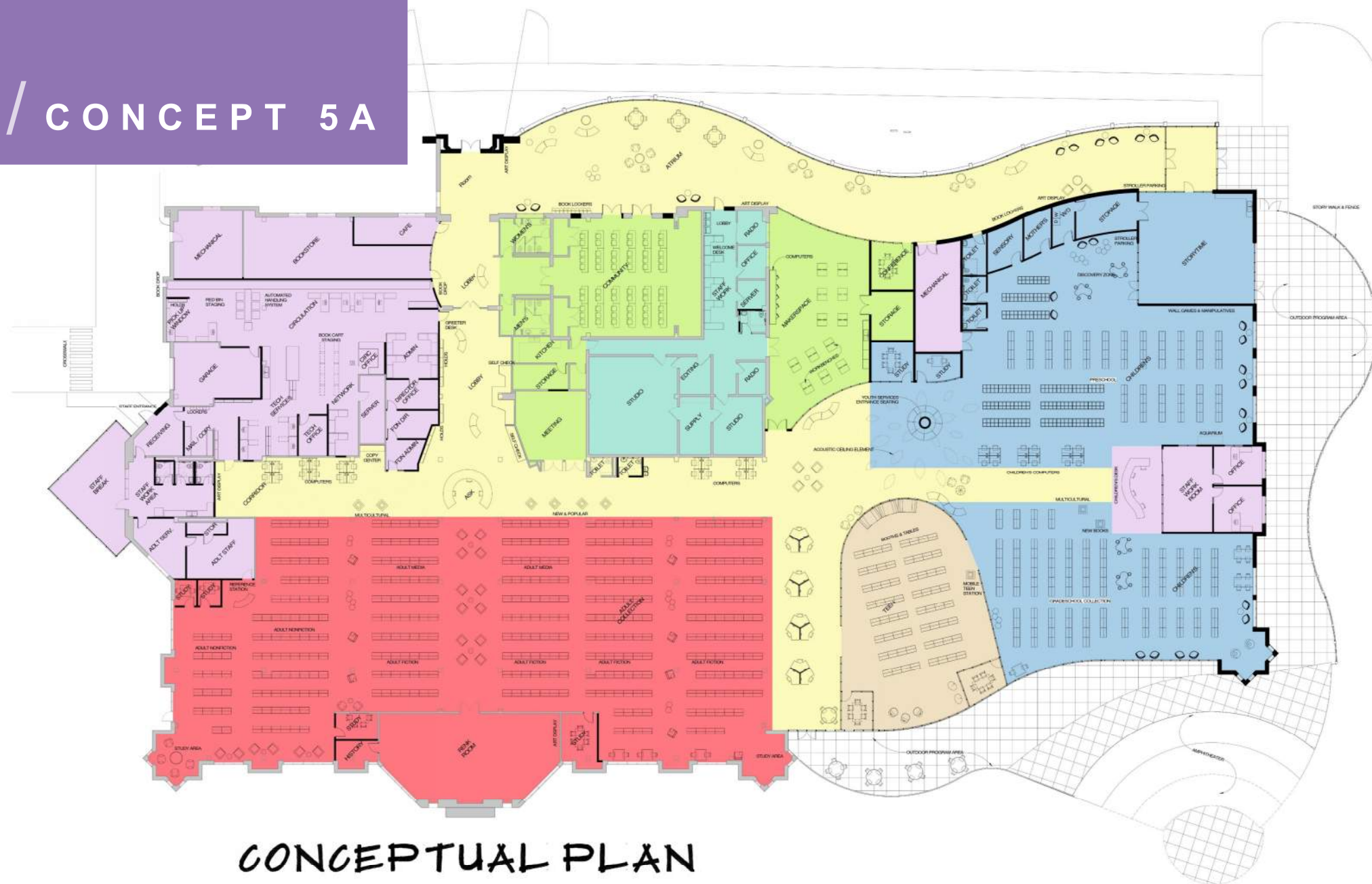

CONCEPTUAL PLAN

05 / BUDGET

OPINION OF PROBABLE COST

OPTION 5a - \$19,989,000

- Increased square footage due to new census data and municipal population projections
- Post-pandemic service considerations
- Updated sustainability features
- Significant increase of construction costs for building and site
- 2024 cost projections

OPINION OF PROBABLE COST

Project No. 202004
 Prepared By: [Signature]
 Project Name: [Blank]

Date 2/15/20
 Reviewer: [Signature]

CHURCH LA - 10th - 1st Floor Project Budget ADJUSTED BIDDING - LARGEST ADJUSTED, 1.00% LOWER

Building Construction Costs

Item	Description	Unit	Quantity	Unit Price	Amount	Notes
1	Site: 10th St. 10th St. 10th St. 10th St.					
2	Excavation of existing 1st floor building (10' x 10' x 10')	cu yd	100	10.00	1,000.00	
3	Foundation of existing 1st floor building (10' x 10' x 10')	sq ft	100	10.00	1,000.00	
4	Foundation of existing 1st floor building (10' x 10' x 10')	sq ft	100	10.00	1,000.00	
5	Foundation of existing 1st floor building (10' x 10' x 10')	sq ft	100	10.00	1,000.00	
6	Foundation of existing 1st floor building (10' x 10' x 10')	sq ft	100	10.00	1,000.00	
7	Foundation of existing 1st floor building (10' x 10' x 10')	sq ft	100	10.00	1,000.00	
8	Foundation of existing 1st floor building (10' x 10' x 10')	sq ft	100	10.00	1,000.00	
9	Foundation of existing 1st floor building (10' x 10' x 10')	sq ft	100	10.00	1,000.00	
10	Foundation of existing 1st floor building (10' x 10' x 10')	sq ft	100	10.00	1,000.00	
11	Foundation of existing 1st floor building (10' x 10' x 10')	sq ft	100	10.00	1,000.00	
12	Foundation of existing 1st floor building (10' x 10' x 10')	sq ft	100	10.00	1,000.00	
13	Foundation of existing 1st floor building (10' x 10' x 10')	sq ft	100	10.00	1,000.00	
14	Foundation of existing 1st floor building (10' x 10' x 10')	sq ft	100	10.00	1,000.00	
15	Foundation of existing 1st floor building (10' x 10' x 10')	sq ft	100	10.00	1,000.00	
16	Foundation of existing 1st floor building (10' x 10' x 10')	sq ft	100	10.00	1,000.00	
17	Foundation of existing 1st floor building (10' x 10' x 10')	sq ft	100	10.00	1,000.00	
18	Foundation of existing 1st floor building (10' x 10' x 10')	sq ft	100	10.00	1,000.00	
19	Foundation of existing 1st floor building (10' x 10' x 10')	sq ft	100	10.00	1,000.00	
20	Foundation of existing 1st floor building (10' x 10' x 10')	sq ft	100	10.00	1,000.00	
21	Foundation of existing 1st floor building (10' x 10' x 10')	sq ft	100	10.00	1,000.00	
22	Foundation of existing 1st floor building (10' x 10' x 10')	sq ft	100	10.00	1,000.00	
23	Foundation of existing 1st floor building (10' x 10' x 10')	sq ft	100	10.00	1,000.00	
24	Foundation of existing 1st floor building (10' x 10' x 10')	sq ft	100	10.00	1,000.00	
25	Foundation of existing 1st floor building (10' x 10' x 10')	sq ft	100	10.00	1,000.00	
26	Foundation of existing 1st floor building (10' x 10' x 10')	sq ft	100	10.00	1,000.00	
27	Foundation of existing 1st floor building (10' x 10' x 10')	sq ft	100	10.00	1,000.00	
28	Foundation of existing 1st floor building (10' x 10' x 10')	sq ft	100	10.00	1,000.00	
29	Foundation of existing 1st floor building (10' x 10' x 10')	sq ft	100	10.00	1,000.00	
30	Foundation of existing 1st floor building (10' x 10' x 10')	sq ft	100	10.00	1,000.00	
31	Foundation of existing 1st floor building (10' x 10' x 10')	sq ft	100	10.00	1,000.00	
32	Foundation of existing 1st floor building (10' x 10' x 10')	sq ft	100	10.00	1,000.00	
33	Foundation of existing 1st floor building (10' x 10' x 10')	sq ft	100	10.00	1,000.00	
34	Foundation of existing 1st floor building (10' x 10' x 10')	sq ft	100	10.00	1,000.00	
35	Foundation of existing 1st floor building (10' x 10' x 10')	sq ft	100	10.00	1,000.00	
36	Foundation of existing 1st floor building (10' x 10' x 10')	sq ft	100	10.00	1,000.00	
37	Foundation of existing 1st floor building (10' x 10' x 10')	sq ft	100	10.00	1,000.00	
38	Foundation of existing 1st floor building (10' x 10' x 10')	sq ft	100	10.00	1,000.00	
39	Foundation of existing 1st floor building (10' x 10' x 10')	sq ft	100	10.00	1,000.00	
40	Foundation of existing 1st floor building (10' x 10' x 10')	sq ft	100	10.00	1,000.00	
41	Foundation of existing 1st floor building (10' x 10' x 10')	sq ft	100	10.00	1,000.00	
42	Foundation of existing 1st floor building (10' x 10' x 10')	sq ft	100	10.00	1,000.00	
43	Foundation of existing 1st floor building (10' x 10' x 10')	sq ft	100	10.00	1,000.00	
44	Foundation of existing 1st floor building (10' x 10' x 10')	sq ft	100	10.00	1,000.00	
45	Foundation of existing 1st floor building (10' x 10' x 10')	sq ft	100	10.00	1,000.00	
46	Foundation of existing 1st floor building (10' x 10' x 10')	sq ft	100	10.00	1,000.00	
47	Foundation of existing 1st floor building (10' x 10' x 10')	sq ft	100	10.00	1,000.00	
48	Foundation of existing 1st floor building (10' x 10' x 10')	sq ft	100	10.00	1,000.00	
49	Foundation of existing 1st floor building (10' x 10' x 10')	sq ft	100	10.00	1,000.00	
50	Foundation of existing 1st floor building (10' x 10' x 10')	sq ft	100	10.00	1,000.00	
51	Foundation of existing 1st floor building (10' x 10' x 10')	sq ft	100	10.00	1,000.00	
52	Foundation of existing 1st floor building (10' x 10' x 10')	sq ft	100	10.00	1,000.00	
53	Foundation of existing 1st floor building (10' x 10' x 10')	sq ft	100	10.00	1,000.00	
54	Foundation of existing 1st floor building (10' x 10' x 10')	sq ft	100	10.00	1,000.00	
55	Foundation of existing 1st floor building (10' x 10' x 10')	sq ft	100	10.00	1,000.00	
56	Foundation of existing 1st floor building (10' x 10' x 10')	sq ft	100	10.00	1,000.00	
57	Foundation of existing 1st floor building (10' x 10' x 10')	sq ft	100	10.00	1,000.00	
58	Foundation of existing 1st floor building (10' x 10' x 10')	sq ft	100	10.00	1,000.00	
59	Foundation of existing 1st floor building (10' x 10' x 10')	sq ft	100	10.00	1,000.00	
60	Foundation of existing 1st floor building (10' x 10' x 10')	sq ft	100	10.00	1,000.00	
61	Foundation of existing 1st floor building (10' x 10' x 10')	sq ft	100	10.00	1,000.00	
62	Foundation of existing 1st floor building (10' x 10' x 10')	sq ft	100	10.00	1,000.00	
63	Foundation of existing 1st floor building (10' x 10' x 10')	sq ft	100	10.00	1,000.00	
64	Foundation of existing 1st floor building (10' x 10' x 10')	sq ft	100	10.00	1,000.00	
65	Foundation of existing 1st floor building (10' x 10' x 10')	sq ft	100	10.00	1,000.00	
66	Foundation of existing 1st floor building (10' x 10' x 10')	sq ft	100	10.00	1,000.00	
67	Foundation of existing 1st floor building (10' x 10' x 10')	sq ft	100	10.00	1,000.00	
68	Foundation of existing 1st floor building (10' x 10' x 10')	sq ft	100	10.00	1,000.00	
69	Foundation of existing 1st floor building (10' x 10' x 10')	sq ft	100	10.00	1,000.00	
70	Foundation of existing 1st floor building (10' x 10' x 10')	sq ft	100	10.00	1,000.00	
71	Foundation of existing 1st floor building (10' x 10' x 10')	sq ft	100	10.00	1,000.00	
72	Foundation of existing 1st floor building (10' x 10' x 10')	sq ft	100	10.00	1,000.00	
73	Foundation of existing 1st floor building (10' x 10' x 10')	sq ft	100	10.00	1,000.00	
74	Foundation of existing 1st floor building (10' x 10' x 10')	sq ft	100	10.00	1,000.00	
75	Foundation of existing 1st floor building (10' x 10' x 10')	sq ft	100	10.00	1,000.00	
76	Foundation of existing 1st floor building (10' x 10' x 10')	sq ft	100	10.00	1,000.00	
77	Foundation of existing 1st floor building (10' x 10' x 10')	sq ft	100	10.00	1,000.00	
78	Foundation of existing 1st floor building (10' x 10' x 10')	sq ft	100	10.00	1,000.00	
79	Foundation of existing 1st floor building (10' x 10' x 10')	sq ft	100	10.00	1,000.00	
80	Foundation of existing 1st floor building (10' x 10' x 10')	sq ft	100	10.00	1,000.00	
81	Foundation of existing 1st floor building (10' x 10' x 10')	sq ft	100	10.00	1,000.00	
82	Foundation of existing 1st floor building (10' x 10' x 10')	sq ft	100	10.00	1,000.00	
83	Foundation of existing 1st floor building (10' x 10' x 10')	sq ft	100	10.00	1,000.00	
84	Foundation of existing 1st floor building (10' x 10' x 10')	sq ft	100	10.00	1,000.00	
85	Foundation of existing 1st floor building (10' x 10' x 10')	sq ft	100	10.00	1,000.00	
86	Foundation of existing 1st floor building (10' x 10' x 10')	sq ft	100	10.00	1,000.00	
87	Foundation of existing 1st floor building (10' x 10' x 10')	sq ft	100	10.00	1,000.00	
88	Foundation of existing 1st floor building (10' x 10' x 10')	sq ft	100	10.00	1,000.00	
89	Foundation of existing 1st floor building (10' x 10' x 10')	sq ft	100	10.00	1,000.00	
90	Foundation of existing 1st floor building (10' x 10' x 10')	sq ft	100	10.00	1,000.00	
91	Foundation of existing 1st floor building (10' x 10' x 10')	sq ft	100	10.00	1,000.00	
92	Foundation of existing 1st floor building (10' x 10' x 10')	sq ft	100	10.00	1,000.00	
93	Foundation of existing 1st floor building (10' x 10' x 10')	sq ft	100	10.00	1,000.00	
94	Foundation of existing 1st floor building (10' x 10' x 10')	sq ft	100	10.00	1,000.00	
95	Foundation of existing 1st floor building (10' x 10' x 10')	sq ft	100	10.00	1,000.00	
96	Foundation of existing 1st floor building (10' x 10' x 10')	sq ft	100	10.00	1,000.00	
97	Foundation of existing 1st floor building (10' x 10' x 10')	sq ft	100	10.00	1,000.00	
98	Foundation of existing 1st floor building (10' x 10' x 10')	sq ft	100	10.00	1,000.00	
99	Foundation of existing 1st floor building (10' x 10' x 10')	sq ft	100	10.00	1,000.00	
100	Foundation of existing 1st floor building (10' x 10' x 10')	sq ft	100	10.00	1,000.00	

Site Work Construction Costs

Item	Description	Unit	Quantity	Unit Price	Amount	Notes
1	Site: 10th St. 10th St. 10th St. 10th St.					
2	Excavation of existing 1st floor building (10' x 10' x 10')	cu yd	100	10.00	1,000.00	
3	Foundation of existing 1st floor building (10' x 10' x 10')	sq ft	100	10.00	1,000.00	
4	Foundation of existing 1st floor building (10' x 10' x 10')	sq ft	100	10.00	1,000.00	
5	Foundation of existing 1st floor building (10' x 10' x 10')	sq ft	100	10.00	1,000.00	
6	Foundation of existing 1st floor building (10' x 10' x 10')	sq ft	100	10.00	1,000.00	
7	Foundation of existing 1st floor building (10' x 10' x 10')	sq ft	100	10.00	1,000.00	
8	Foundation of existing 1st floor building (10' x 10' x 10')	sq ft	100	10.00	1,000.00	
9	Foundation of existing 1st floor building (10' x 10' x 10')	sq ft	100	10.00	1,000.00	
10	Foundation of existing 1st floor building (10' x 10' x 10')	sq ft	100	10.00	1,000.00	
11	Foundation of existing 1st floor building (10' x 10' x 10')	sq ft	100	10.00	1,000.00	
12	Foundation of existing 1st floor building (10' x 10' x 10')	sq ft	100	10.00	1,000.00	
13	Foundation of existing 1st floor building (10' x 10' x 10')	sq ft	100	10.00	1,000.00	
14	Foundation of existing 1st floor building (10' x 10' x 10')	sq ft	100	10.00	1,000.00	
15	Foundation of existing 1st floor building (10' x 10' x 10')	sq ft	100	10.00	1,000.00	
16	Foundation of existing 1st floor building (10' x 10' x 10')	sq ft	100	10.00	1,000.00	
17	Foundation of existing 1st floor building (10' x 10' x 10')	sq ft	100	10.00	1,000.00	
18	Foundation of existing 1st floor building (10' x 10' x 10')	sq ft	100	10.00	1,000.00	
19	Foundation of existing 1st floor building (10' x 10' x 10')	sq ft	100	10.00	1,000.00	
20	Foundation of existing 1st floor building (10' x 10' x 10')	sq ft	100	10.00	1,000.00	
21	Foundation of existing 1st floor building (10' x 10' x 10')	sq ft	100	10.00	1,000.00	
22	Foundation of existing 1st floor building (10' x 10' x 10')	sq ft	100	10.00	1,000.00	
23	Foundation of existing 1st floor building (10' x 10' x 10')	sq ft	100	10.00	1,000.00	
24	Foundation of existing 1st floor building (10' x 10' x 10')	sq ft	100	10.00	1,000.00	
25	Foundation of existing 1st floor building (10' x 10' x 10')	sq ft	100	10.00	1,000.00	
26	Foundation of existing 1st floor building (10' x 10' x 10')	sq ft	100	10.00	1,000.00	
27	Foundation of existing 1st floor building (10' x 10' x 10')	sq ft	100	10.00	1,000.00	
28	Foundation of existing 1st floor building (10' x 10' x 10')	sq ft	100	10.00	1,000.00	
29	Foundation of existing 1st floor building (10' x 10' x 10')	sq ft	100	10.00	1,000.00	
30	Foundation of existing 1st floor building (10' x 10' x 10')	sq ft	100	10.00	1,000.00	
31	Foundation of existing 1st floor building (10' x 10' x 10')	sq ft	100	10.00	1,000.00	
32	Foundation of existing 1st floor building (10' x 10' x 10')	sq ft	100	10.00	1,000.00	
33	Foundation of existing 1st floor building (10' x 10' x 10')	sq ft	100	10.00	1,000.00	
34	Foundation of existing 1st floor building (10' x 10' x 10')	sq ft	100	10.00	1,000.00	
35	Foundation of existing 1st floor building (10' x 10' x 10')	sq ft	100	10.00	1,000.00	
36	Foundation of existing 1st floor building (10' x 10' x 10')	sq ft	100	10.00	1,000.00	
37	Foundation of existing 1st floor building (10' x 10' x 10')	sq ft	100	10.00	1,000.00	
38	Foundation of existing 1st floor building (10' x 10' x 10')	sq ft	100	10.00	1,000.00	
39	Foundation of existing 1st floor building (10' x 10' x 10')	sq ft	100	10.00	1,000.00	
40	Foundation of existing 1st floor building (10' x 10' x 10')	sq ft	100	10.00	1,000.00	
41	Foundation of existing 1st floor building (10' x 10' x 10')	sq ft	100	10.00	1,000.00	
42	Foundation of existing 1st floor building (10' x 10' x 10')	sq ft	100	10.00	1,000.00	
43	Foundation of existing 1st floor building (10' x 10' x 10')	sq ft	100	10.00	1,000.00	
44	Foundation of existing 1st floor building (10' x 10' x 10')	sq ft	100	10.00	1,000.00	
45	Foundation of existing 1st floor building (10' x 10' x 10')	sq ft	100	10.00	1,000.00	
46	Foundation of existing 1st floor building (10' x 10' x 10')	sq ft	100	10.00	1,000.00	
47	Foundation of existing 1st floor building (10' x 10' x 10')	sq ft	100	10.00	1,000.00	
48	Foundation of existing 1st floor building (10'					

05 / BUDGET

OPINION OF PROBABLE COST

Owner: Sun Prairie Public Library

Project : Library Expansion

Project No.: 2018304

Phase: Conceptual Design

Date : 12/8/21

Estimator : KE/AD

Concept 5A - FEH - Total Project Budget
36,100SF EXISTING, 23,000SF ADDITION, 5,900SF LOBBY

1/30/2020 Comparison

DESCRIPTION		QTY	UNIT	COST/SF	TOTALS	2020 BUDGET TOTAL COMPARISON	
Building Construction Costs:							
New construction							
1	New Addition: 23,000 SF plus glass lobby 5,900 SF	28,900	SF	255.00	7,369,500	20,283SF @ \$233/SF	4,523,109
2	Renovation of existing Library building: replace HVAC equipment	36,100	SF	19.00	685,900	34,717SF @ \$11.90/SF	413,132
3	Renovation of existing Library Building: replace existing with LED light fixtures	36,100	SF	15.00	541,500	34,717SF @ \$15.00/SF	520,755
4	Renovation of existing Library Building: power distribution for furniture	22,900	SF	2.50	57,250	34,717SF @ \$2.50/SF	86,793
5	Renovation of existing Library Building: ADA Compliance, staff restrooms, doors, flooring, signage, acoustics, from May 2018 report	1	LS	40,000.00	40,000	LUMP SUM	119,450
6	Renovation of existing Library building: complete EPDM roof system replacement/flashing repair	19,800	SF	10.50	207,900	19,800SF @ \$7.25/SF	143,550
7	Renovation at demolition/renovation areas, Porch	10,625	SF	25.00	265,625	NONE	
8	Renovation of existing Library building: remove and replace carpet	26,000	SF	4.50	117,000	20,000SF @ \$4.50/SF	90,000
9	Renovation of existing Library building: replace ACT ceilings	9,000	SF	2.50	22,500	10,000SF @ \$7.00/SF	70,000
10	Renovation of existing Library building while occupied in a phased manner:	36,100	SF	2.00	72,200	34,717SF @ \$2.00/SF	69,434
11	May 2018 condition assessment items excluding those listed above	1	LS	192,000.00	192,000	LUMP SUM	174,640
12	Storefront	2,800	SF	55.00	154,000		0
13	Hybrid AV technology for meeting rooms	1	LS	200,000.00	200,000		0
Demo							0
14	Demo interior	9,000	SF	8.00	72,000		0
							0
SubTotal					9,997,375		6,210,863
Design / Bid Contingency 15%					1,499,606	10% Contingency	621,086
Building Construction Costs SubTotal					11,496,981		6,831,949
Construction Contingency 5%					574,849	5% Contingency	341,597
BUILDING CONSTRUCTION COST TOTAL					\$12,071,830	Total	\$7,173,547

05 / BUDGET

Site Work Construction Costs						
15	Structure Deconstruction - porch (ONE)	625	SF	7	4,375	1,250SF @ \$7.00/SF 8,750
16	Relocate trees	22	EA	750	16,500	22 EA @ \$750 PER 16,500
17	Remove foundations - porch	625	SF	1	625	1250SF @ \$1.00/SF 1,250
18	Hazard Material survey, sample, test	0	LS	7500	0	0
19	Hazardous material abatement	0	SF	6	0	0
20	New Parking Spaces & Drive Lane	60,000	SF	9.00	540,000	46,900SF @ \$9.00/SF 422,100
21	Renovation of existing Library parking lot: resurface lot w/ thermo plastic overlay	10,500	SY	6.00	63,000	9,903 SY @ \$6.00/SY 59,418
22	Renovation of existing Library parking lot: repave w/ 1" asphalt wear course overlay	9,903	SY	8.20	81,205	9,903 SY @ \$8.20/SY 81,205
23	Concrete Curb and Gutter	2,300	LF	14.00	32,200	2,060LF @ \$12.00/LF 24,720
24	Children's and Adult Outdoor Program area	5,900	SF	8.00	47,200	1000SF @ \$8.00/SF 8,000
25	Amphitheater	2,000	SF	36.00	72,000	NONE 0
26	Storm Sewer	425	LF	75	31,875	360LF @ \$32.00/LF 11,520
27	Domestic Water	220	LF	75	16,500	360LF @ \$26.00/LF 9,360
28	Sanitary Sewer	220	LF	90	19,800	360LF @ \$38.00/LF 13,680
29	Electrical service, transformer	1	LS	24,000	24,000	LUMP SUM 24,000
30	Relocate power lines & poles	1	LS	10,000	10,000	NONE 0
31	Fill material	8,700	CY	20	174,000	NONE 0
32	Retaining Walls	160	LF	120	19,200	NONE 0
33	Pedestrian Paving,	2,000	SF	4.00	8,000	5,500SF @ \$2.00/SF 11,100
34	Renovation of existing Library parking lot: remove gravel and add soil	10,125	SF	3.60	36,450	10,125SF @ \$3.60/SF 36,450
35	Renovation of existing Library parking lot: landscape the islands	15,000	SF	8.00	120,000	10,125SF @ \$14.00/SF 141,750
36	Roof canopy	1,400	LS	30	42,000	1,400LS @ \$30.00/LS 42,000
37	Flag pole	0	LS	2,800	0	NONE 0
38	Directional & Informational Signage - signage, electronic site sign and building	1	LS	24,000	24,000	LUMP SUM 24,000
39	Bioretention Basin	15,000	SF	25.00	375,000	NONE 0
40	Parking lot lighting	8	EA	1,900	15,200	8 EA @ \$1,900/EA 15,200
41	Electric charging stations	4	EA	7,500	30,000	NONE 0
42	Solar Panels - 100 KW	100	KW	2,100	210,000	100KW @ 1,730/KW 173,000
SubTotal					2,013,130	Subtotal 1,124,003
Design / Bid Contingency 10%					201,313	112,400
Site Work Construction Costs SubTotal					2,214,443	1,236,403
Construction Contingency 5%					110,722	61,820
SITE WORK CONSTRUCTION COST TOTAL					\$2,325,165	Site Work Total \$1,298,223

05 / BUDGET

43	Land Acquisition	1	LS		0		0
44	Legal Fees	1	LS		10,000		10,000
45	Architectural & Engineering Design Fees	1	LS		1,259,737		741,280
46	Sustainable Design Fees	1		50,000.00	50,000		0
47	Information & Technology Design Fees	1	LS		29,520		25,588
48	Furnishing Design, Selection, Bidding Fees	1	LS		159,016		240,560
49	Geo Thermal Horizontal Test Well	1	LS		12,000		12,000
50	Site Survey (utilize existing facility documents)	1	LS		6,500		6,500
51	Printing Costs/Electronic Plan Room for Construction Documents-verify	1	LS		11,000		8,500
52	Construction documents review Fees	1	LS		10,000		10,000
53	Builders Risk Insurance	1	LS		7,000		7,000
54	Quality Control Material Testing & Inspections	1	LS		30,000		30,000
55	Construction Utility by Owner	1	LS		10,000		10,000
56	Furniture, Furnishings & Equipment Allowance \$28/SF new	25,400	SF	28.00	711,200	53,308SF @ \$24.00/SF	1,279,392
57	Furniture, Furnishings & Equipment Allowance \$16/SF existing	32,000	SF	16.00	512,000	35,692SF @ \$16.00/SF	571,072
58	Technology & Computer Equipment Allowance	61,500	SF	6.00	369,000	53,308SF @ \$6.00/SF	319,848
59	Energy & Utility Rebates	1	LS		(15,000)		(15,000)
60	Geotechnical subsurface investigation	1	LS		7,500		7,500
61	Moving Collection	1	LS		40,000		12,000
62	Ground breaking and dedication ceremonies	1	LS		3,000		3,000
63	LEED certification services	1	LS	12,000.00	12,000		0
64	Library Programming	1	LS		30,000		30,000
65	Owners Representative	1	LS	0.00	0		423,588
66	Smart Locker System	1	EA	50,000.00	50,000		0
67	Commissioning	1	LS	30,000.00	30,000		0
68	Reimbursable expenses	1	LS		18,000		18,000
69	Referendum Campaign Facilitation	1	LS		0		30,000
70	Fundraising Consulting & grant writing	1	LS		0		75,000
Soft Cost SubTotal					3,362,473		3,855,828
Site Work Construction Cost Total					2,325,165		1,298,223
Building Construction Cost Total					12,071,830		7,173,547
PROJECT TOTAL COST 2021					\$17,759,468	2020 Total Cost	12,327,598
						2022 Project Cost	13,067,254
						2024 Project Cost	14,300,014

Inflation 3% per year for 2021, 2022, 2023, and 2024

PROJECT TOTAL COST 2024 **\$19,968,281**

Optional sustainability strategies

Permeable concrete at new paving 60,000 SF x \$6/SF

Water Reclamation

Energy Efficiency to exceed 2021 IECC code

Microgrid batteries

\$360,000

\$90,000

\$250,000

to be determined

06/ EXTERIOR RENDERING



06/ EXTERIOR RENDERING



FEH DESIGN

07 / TIMELINE

NEXT STEPS

- Conceptual design floor plan, exterior renderings to be presented to the Library Board in December 2021
- Presentation to Sun Prairie Committee of the Whole
- Interior rendering to be presented to the Library Board in January 2022
- Presentation to Sun Prairie Committee of the Whole in 2022
- Compilation of the conceptual design booklet

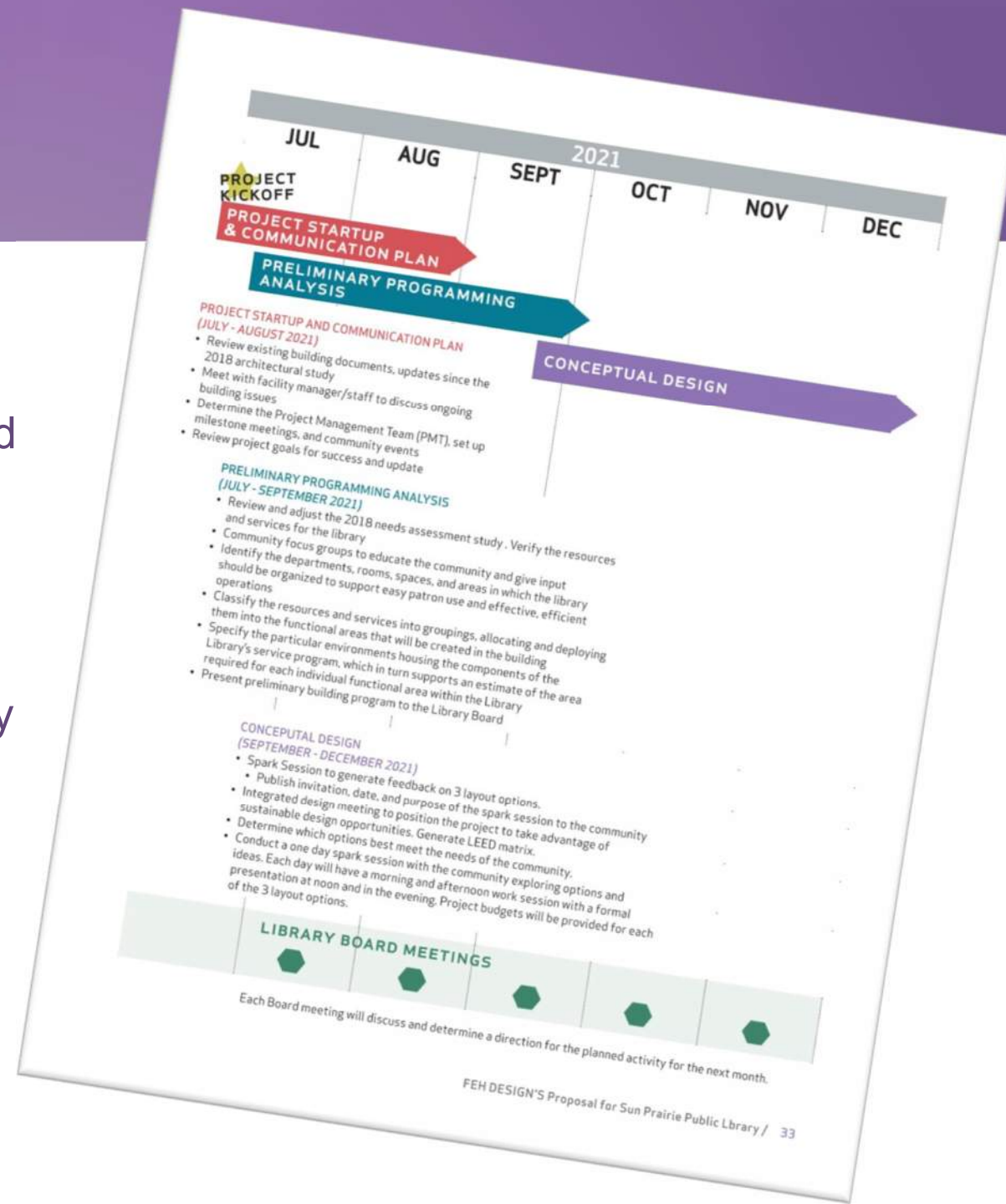



Questions?



THANKS!