

ARCHITECTURE / ENGINEERING / INTERIORS



**FEH** DESIGN

# SUN PRAIRIE PUBLIC LIBRARY

CITY OF SUN PRAIRIE  
SPARK SESSION



**SUN PRAIRIE**  
PUBLIC LIBRARY

# TEAM

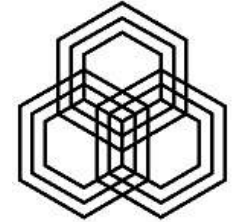

Aaron Davis, AIA  
Principal in Charge



Christy Monk, AIA,  
LEED AP BD+C  
Project Manager



Anders Dahlgren,  
Library Planner



Gregg Baum, AIA,  
LEED AP  
Library Expert



Kevin Eipperle, AIA,  
LEED AP  
Architect



Katie Stork  
Spark Hostess



Karen Greiner, IIDA  
Interior Designer



Miranda Seals, Assoc. AIA  
Intern Architect



Scott Anderson, PE  
Civil Engineer

# 01 / GOALS FOR SUCCESS

- Ensure that we serve the community needs for the next 20 years
- Grow with Sun Prairie socio- economic needs
- Improve infrastructure for comfort, aesthetics, safety, and security
- Core Values tied to physical space to reflect culture
- Provide adequate space to support collections and programs
  - Consideration for flexible space and outdoor spaces including a Maker Space
  - Space for Foundation Executive Director and Storage
- Remove barriers to serve all members of our community
- Provide more flexible access
  - • Consideration to maintain and enhance the drive-up window to serve patrons
- Be an example by being good stewards - financially, environmentally and culturally sustainable
- Library as an essential destination
- Promote and foster life-long learning and creativity
- Create an environment that continues to be comfortable...maintain current integrity of our “GEM” inside and outside
- Exposure to Art – local and national
- Facilitate communication using technology
- Provide broad collection access for the community

# 02 / 2018 CONCEPT

## ESSENTIAL PLANNING PARAMETERS



Service population (est) = 58,250 (year 2040)  
Municipal Population of 45,580

Resource inventory including

- 250,000 items in the collection
- 72 technology stations for public use
- 170 reader seats
- 44 staff work stations
- 200 seat capacity in multi-purpose room 1
- 120 capacity in multi-purpose room 2
- 14 capacity in a conference room
- 65 capacity in children's multi-purpose room

Dedicated allowances for Sun Prairie Media Center,  
Friends bookstore + sorting, children's discovery zone,  
24/7 delivery lockers or dispenser device

Recommended space need = 89,100 square feet

## 02 / 2018 CONCEPT

## ADVISORY TASK FORCE AND LIBRARY STEERING COMMITTEE RECOMMENDATION





# 03 / 2019 CONCEPT (BRANCHING)

## ESSENTIAL PLANNING PARAMETERS



What happens if the library adds 1 or 2 branches?

Resource inventory including

- 175,000 items (75,000 at branches)

- 50 tech stations (22 at branches)

- 120 reader seats (50 at branches)

- 54 staff work stations\*

- 200 seat capacity in multi-purpose room 1

- 120 capacity in multi-purpose room 2

- 14 capacity in a conference room

- 65 capacity in children's multi-purpose room

Dedicated allowances for Sun Prairie Media Center,  
Friends bookstore + sorting, children's discovery zone,  
24/7 delivery lockers, *and a garage*

Recommended space need = 74,200 square feet

# 04 / 2020 CONCEPT

## ESSENTIAL PLANNING PARAMETERS



What happens if we place greater focus on county standards?

Resource inventory including

- 146,000 items (50,000 at branches)

- 42 tech stations (22 at branches)

- 120 reader seats (50 at branches)

- 42 staff work stations\*

- 120 seat capacity in multi-purpose room 1

- 14 capacity in a conference room

- 65 capacity in children's multi-purpose room

Dedicated allowances for Sun Prairie Media Center, Friends bookstore + sorting, children's discovery zone, 24/7 delivery lockers

Recommended space need = 55,500 square feet

# 04 / 2020 CONCEPT

FEBRUARY 2020 LIBRARY  
BOARD RECOMMENDATION

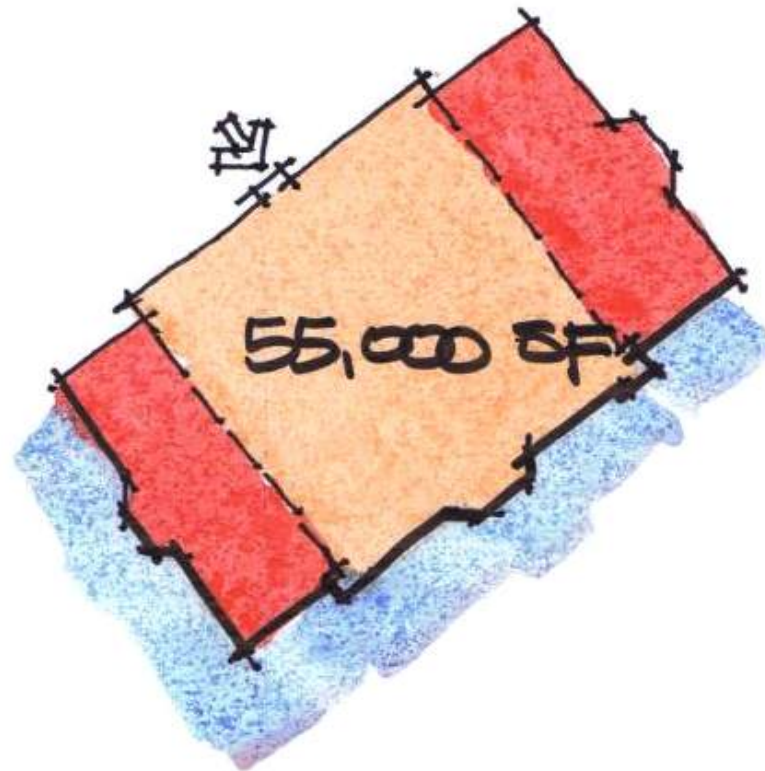

**F**  
OPTION B



# 05 / 2021 CONCEPT

## UPDATING PLANNING PARAMETERS

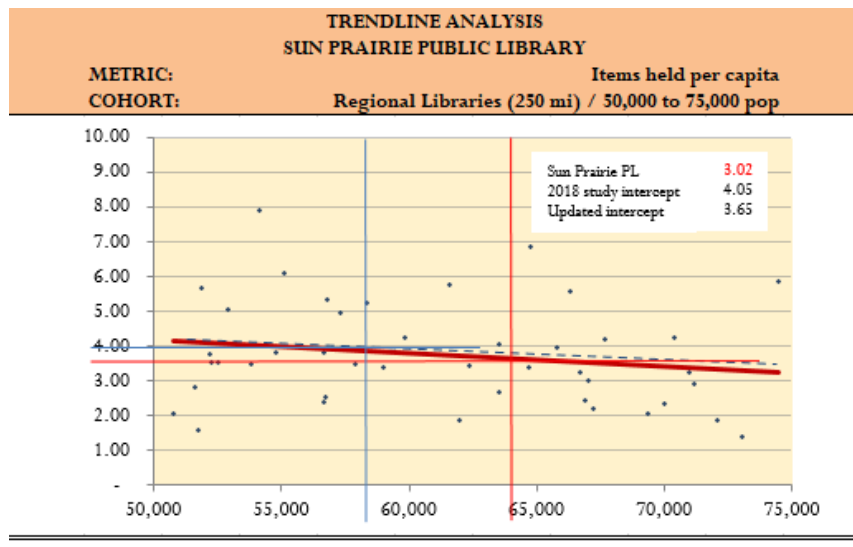

“Planning is a series of approximations to a moving target”  
....Douglas Zweizig

2020 census provides an updated understanding of future service population (60,100 to the year 2040 – 50,100 municipal + 10,000)

Updated service population provides a guide as resource and service inventory goals are revisited

- 195,000 items (165,000 at main, 30,000 at branches)

- 75 technology stations (45 at main)

- 174 reader seats (124 at main)

- 120 capacity in multi-purpose room 2

- 14 capacity in a conference room

- 65 capacity in children’s multi-purpose room

Pandemic protocols inform a richer understanding of staff work station and operational needs, including:

- drive-up service window

- drive-up return

- curbside delivery

- outdoor programming

- contact-less service

- 24/7 access

Recommended space need = 61,500 square feet

# 05 / 2021 CONCEPT

## CURRENT STUDY



# 06 / 2021 FINDINGS

## CONDITION ASSESSMENT UPDATE

- HVAC Equipment is at its end-of-life
- Light fixture levels are inadequate with low energy efficiency
- Power distribution equipment is at its end-of-life
- Roof membrane is at its end-of-life
- Repair to locations with water intrusion
- Parking lot repair and lighting upgrades are needed
- ADA upgrades to door clearances, signage, path of travel
- Sealant at windows and doors is at its end-of-life





# DRIVE UP SERVICES







# OUTDOOR SPACE VISION AND FUNCTION





# MEDIA CENTER & MAKERSPACE





# SUSTAINABILITY





# PARTNERSHIPS & OTHER SERVICES



- Partnerships
  - Daycares
  - Healthcare
  - Food Service
  - Non-Profits
  - Community Organizations
- Workshop/Training for Companies
- Other Services
- 24-hour Lobby
- Book Lockers
- Book Vending Machines
- Express Computer Stations
- Virtual / Wifi



# PROGRAM SPACES



# 08 / TIMELINE

## SCHEDULE

- SPARK Session workshop TODAY!
- Conceptual design, renderings, and recommendation to be presented in December 2021



**SPARK SESSION**

**WEDNESDAY, OCTOBER 27**

**CONVERSATION:** 9:00 AM TO 5:00 PM  
IN THE COMMUNITY ROOM AND ON ZOOM

**FORMAL PRESENTATION:** 5:00 TO 7:00 PM  
ONLY ON ZOOM

**SHARE YOUR IDEAS!**

Join us on Zoom!  
Meeting ID:  
834-4360-1893  
Passcode:  
w5WYT978  
Scan the code to join the zoom meeting.



This is an opportunity for the community to give input on the conceptual design of the expansion & renovation of the library building.

Stop by the library or jump on Zoom to converse with the architects and make your voice heard.

 **SUN PRAIRIE**  
PUBLIC LIBRARY

 **FEH DESIGN**





**Questions?**



**THANKS!**